



lomond

make yourself a home

28 D/L Loanhead Street, Kilmarnock KA1 3AU

Accommodation

Presented within an imposing red sandstone property, this ground floor flat is truly captivating. Conveniently situated on Loanhead Street, right at the heart of Kilmarnock, it offers unrivaled accessibility, not only to the town center but also to the Queens Drive retail park, all within easy walking distance. The property itself is a masterpiece of presentation, boasting immaculate interiors and enjoying the advantages of both communal and private garden spaces.

Meticulously tended to by its current owner, this flat stands as a testament to care and attention. The stylish galley-style kitchen, complete with built-in appliances, exudes modernity and convenience. Its versatile appeal extends to a wide array of potential buyers, including first-time purchasers and those seeking single-level living. The lounge, spacious and elegantly neutral in decor, features an inviting bay window at the front. Complementing the property's allure is a generously proportioned double bedroom. The pièce de résistance, however, lies in the luxurious shower room – a true highlight of this impressive flat. Recently revamped with exquisite taste, the shower room now boasts a stylish suite that includes a walk-in shower cubicle, WC, and wash hand basin. The floors and walls are adorned with captivating feature tiling, adding a touch of sophistication.

Beyond its interiors, the property continues to impress. On-street parking graces the front, while extensive communal gardens foster a sense of community. Additionally, a private garden area offers the perfect spot to bask in the pleasures of summer days and nights.

In summary, this ground floor flat encapsulates a living opportunity that seamlessly combines aesthetic appeal, strategic location, and luxurious living. With its beautifully curated interiors and convenient surroundings, it offers an exceptional chance to savor both comfort and style.

Situation

Loanhead Street is an attractive street located in the heart of Kilmarnock. Known for its rich history and charming atmosphere, Loanhead Street is a hub of activity, offering an array of shops, Dick Institute Museum and eateries as well as fantastic transport links with the town centre and beyond. The town centre of Kilmarnock has an impressive range of amenities including both train and bus station with direct link to Glasgow City Centre, retail parks and cinema.

- Captivating Ground Floor Flat with Modern Interiors
- Unrivaled Accessibility in Prime Location
- Immaculate Presentation with Stunning Details.
- Versatile Appeal for Various Buyers.
- Stylish Kitchen
- Large Double Bedroom
- Luxurious Shower Room Highlight.



 1 Bedrooms

 50 sqm

 1 Public Rooms

 EPC Rating D



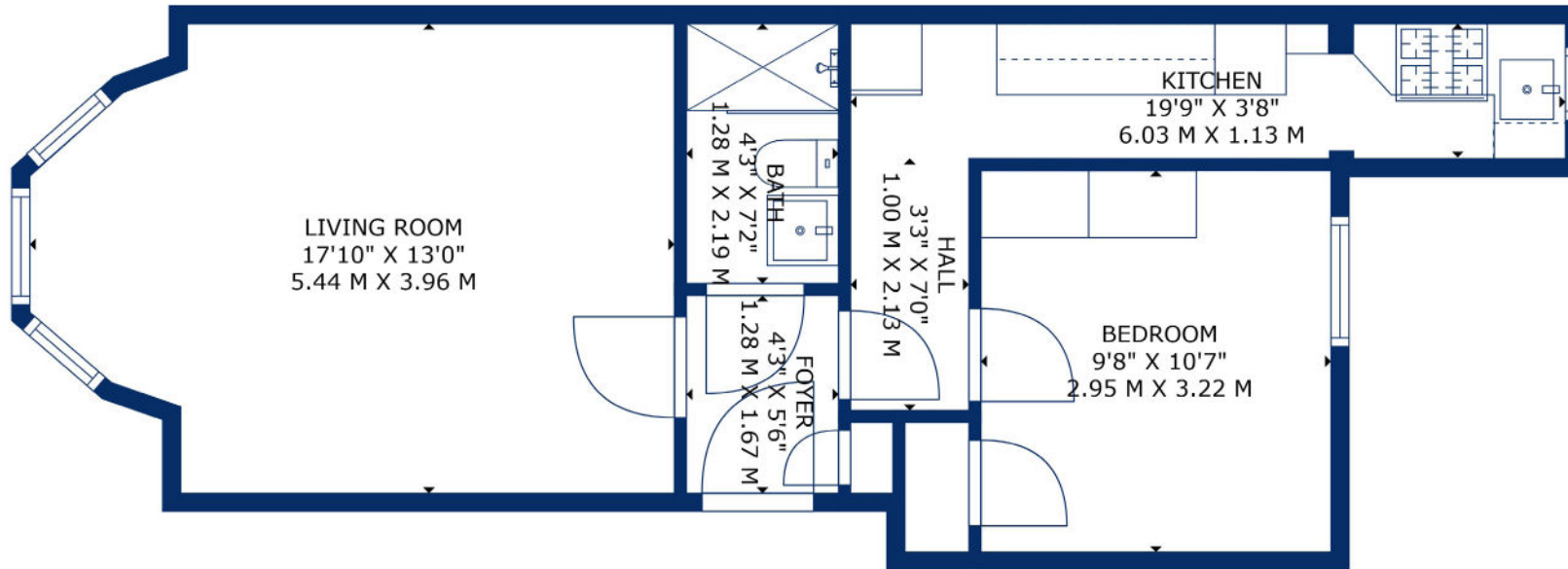

📍 51 Main Street, Prestwick
01292 471511

📍 52 Bank Street, Irvine
01294 317013



Any error, omission, or misstatement in any part of this schedule shall not entitle the purchaser(s) or vendor(s) to entitlement to compensation or damages, nor in circumstances to give either party any cause for action. The selling agents have not tested services, equipment or fittings and are therefore unable to comment on their condition. Potential buyers are requested to contact their solicitor or surveyor if further clarification is required. Measurements are approximate for guidance purposes only and have been taken by a sonic beam and are measured from wall to wall at the widest point unless otherwise indicated. Photographs are reproduced for general information and it must not be inferred that any item is included in the sale.