



lomond
make yourself a home

61B Fullarton Road, Kilmarnock KA1 2JL

Accommodation

Superbly appointed throughout and located on the preferred ground floor whilst being centrally located within the heart of Kilmarnock and with an abundance of amenities literally on the doorstep, this one bedroom flat will be of immediate appeal to all who view given the quality of the accommodation together with well tended gardens.

Having been lovingly cared for by the current owner the property is presented in true walk in condition and benefits from a range of modern fixtures and fittings, perfectly complimented by traditional features. The kitchen is complete with built in appliances as well as a range of wall and floor mounted units. There is a large double bedroom to the front and completing the accommodation is the shower room complete with walk in shower and attractive tiling to the floor and walls. In addition, the property features gas central heating and double glazing as well as a private area of garden and a large communal garden including drying green.

Situation

Fullarton Street is a bustling thoroughfare located in the heart of Kilmarnock. Known for its rich history and charming atmosphere, the immediate area is a hub of activity, offering an array of shops and eateries as well as fantastic transport links with the town centre and beyond. The town centre of Kilmarnock has an impressive range of amenities including both train and bus station with direct link to Glasgow City Centre, retail parks and cinema.

- Traditional Ground Floor Flat
- Communal Gardens
- Large Double Bedrooms
- Modern Kitchen & Bathroom
- Located Within a Central Convenient Location



 1 Bedrooms

 51 sqm

 1 Public Rooms

 EPC Rating D



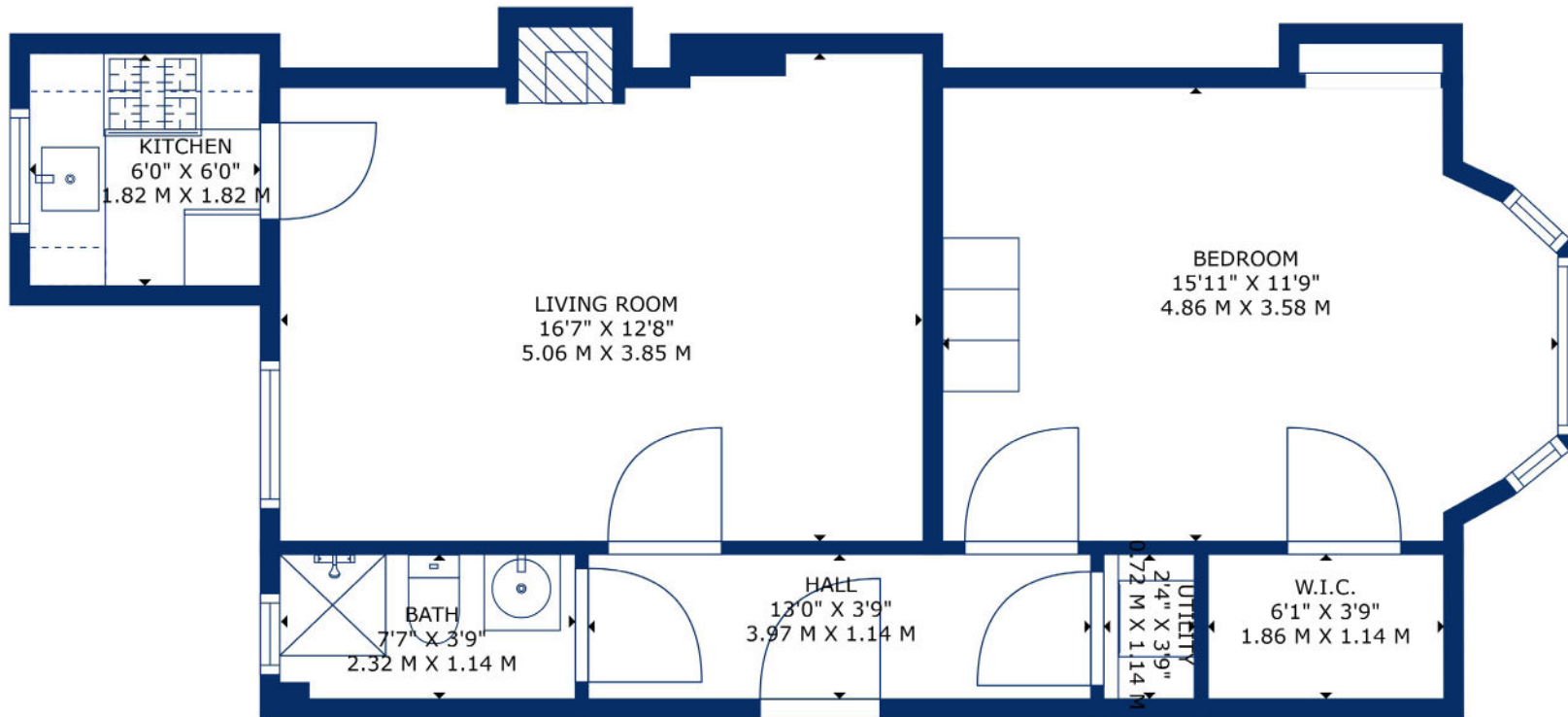

 **51 Main Street, Prestwick**
01292 471511

 **52 Bank Street, Irvine**
01294 317013



Any error, omission, or misstatement in any part of this schedule shall not entitle the purchaser(s) or vendor(s) to entitlement to compensation or damages, nor in circumstances to give either party any cause for action. The selling agents have not tested services, equipment or fittings and are therefore unable to comment on their condition. Potential buyers are requested to contact their solicitor or surveyor if further clarification is required. Measurements are approximate for guidance purposes only and have been taken by a sonic beam and are measured from wall to wall at the widest point unless otherwise indicated. Photographs are reproduced for general information and it must not be inferred that any item is included in the sale.